





Guide price £550,000

1 St. Hubert Road

Waterlooville, PO8 0EJ

- DETACHED CHALET HOME
- SOUTH FACING GARDEN
- FOUR BEDROOMS
- AMPLE DRIVEWAY PARKING
- QUIET HORNDEAN CUL-DE-SAC
- 0.16 ACRE MATURE PLOT
- DOUBLE CAR BARN & GARAGE
- POTENTIAL TO EXTEND (STPP)

Tucked away within a quiet and highly regarded cul-de-sac in Horndean, this detached chalet-style home occupies a generous mature plot of approximately 0.16 acres and offers a rare opportunity for buyers seeking space, privacy and future potential.



Set back from the road behind an extensive driveway, the property enjoys excellent parking provision with a detached garage, double car barn and additional off-road parking for numerous vehicles. The mature frontage and established gardens create an attractive first impression, while the south-facing rear garden provides a private and tranquil setting.

Internally, the accommodation extends to approximately 1,261 sq ft (excluding the garage and car barn) and offers a versatile layout that could suit a variety of lifestyles. The welcoming entrance hall leads to two generous ground floor double bedrooms, both overlooking the front aspect, alongside a ground floor cloakroom and family bathroom.

The heart of the home is the impressive dual-aspect living and dining room, measuring over 21ft in length, providing a wonderful entertaining space with views and direct access onto the rear garden. The adjoining kitchen is well positioned and offers scope for modernisation and potential reconfiguration to create an open-plan kitchen/living arrangement if desired.

To the first floor there are two further bedrooms complemented by a family bathroom. The layout offers flexibility for guests, hobbies, home working or multigenerational living.

Outside, the mature south-facing rear garden is a particular feature, enjoying a high degree of privacy and established planting. The generous plot presents exciting opportunities for extension and enlargement, subject to the necessary planning consents, allowing purchasers to create a substantial family home in this sought-after location.

Conveniently positioned within easy reach of local amenities, countryside walks and transport links, this is a property that combines immediate comfort with significant long-term potential.







Floor Plans

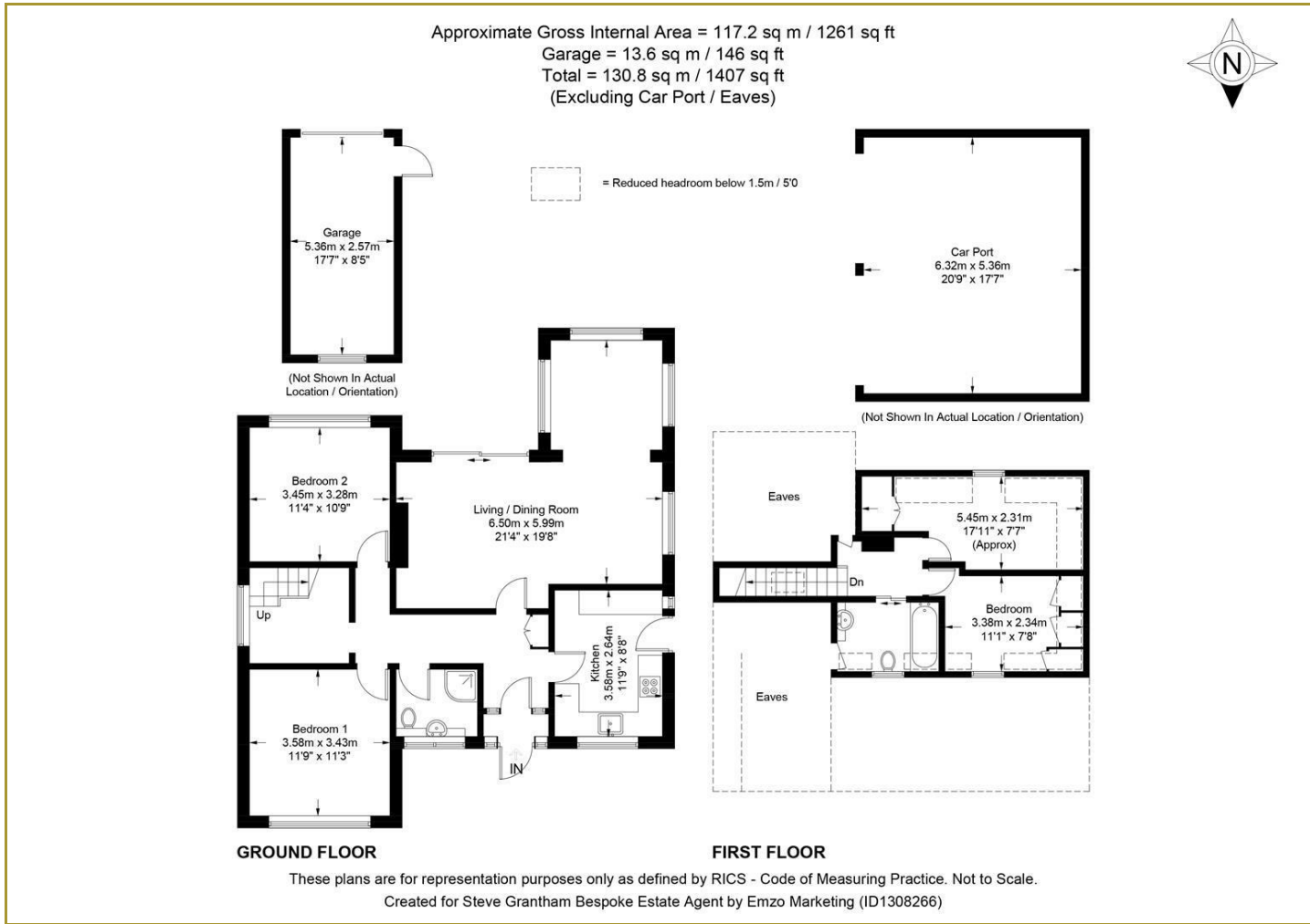

Location Map

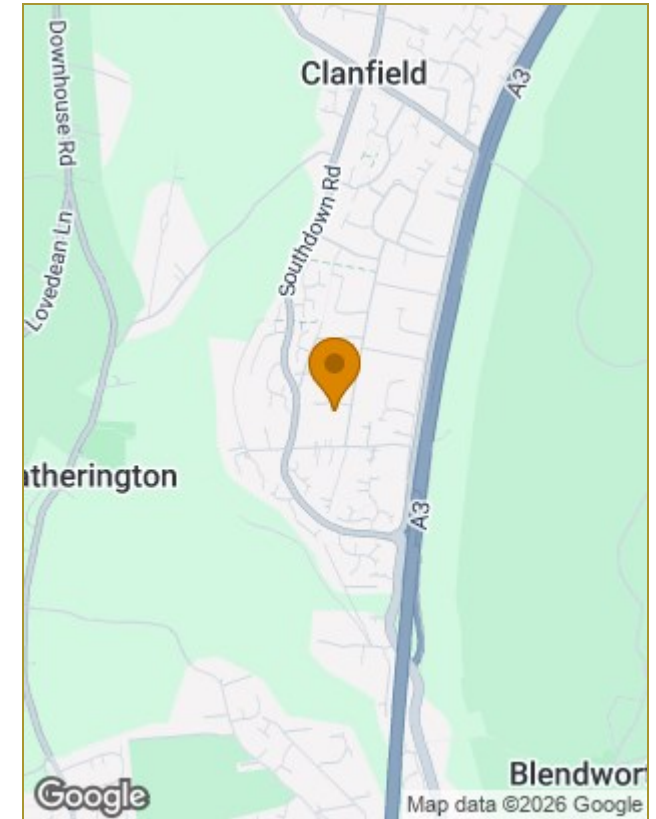

Energy Performance Graph



Should a purchaser(s) have an offer accepted on a property marketed by Steve Grantham Bespoke Estate Agent, they will need to undertake an identification check. This is done to meet our obligation under Anti Money Laundering Regulations (AML) and is a legal requirement. We use a specialist third party service to verify your identity. The cost of these checks is £30 inc. VAT per named purchaser, which is paid in advance, when an offer is agreed and prior to a sales memorandum being issued. This charge is non-refundable under any circumstances.

The particulars are set out as a general outline only for the guidance of intended purchasers or lessees, and do not constitute, any part of a contract. Nothing in these particulars shall be deemed to be a statement that the property is in good structural condition or otherwise nor that any of the services, appliances, equipment or facilities are in good working order. Purchasers should satisfy themselves of this prior to purchasing.